

Bellefields Road | , SW9



**£2,300 PCM**

- 2 bedroom conversion flat • Arranged over top 2 floors • Excellent location • Moments from Brixton tube • Leasehold covenants may apply • On street residents permit parking available on application

Centrally located a spacious split-level conversion flat arranged over the top two floors of a Victorian terraced house. The property comprises a large front reception room, separate modern fitted kitchen/breakfast room, two double bedrooms and shower room (fitted with shower cubicle, wash hand basin and WC). Bellefields Road is brilliantly located just minutes from the town centre and bustling Brixton Village & Pop Brixton. Transport links are excellent with Brixton Victoria Line underground station, main line station and numerous bus routes to the City & West End. The flat itself is perfect for those looking for space and character with internal viewing highly recommended. The flat is available from early June as furnished. Please note photos were taken prior to the current tenancy.

Council tax band C (Lambeth). Deposit £2653. Monthly rent £2300. EPC=C.

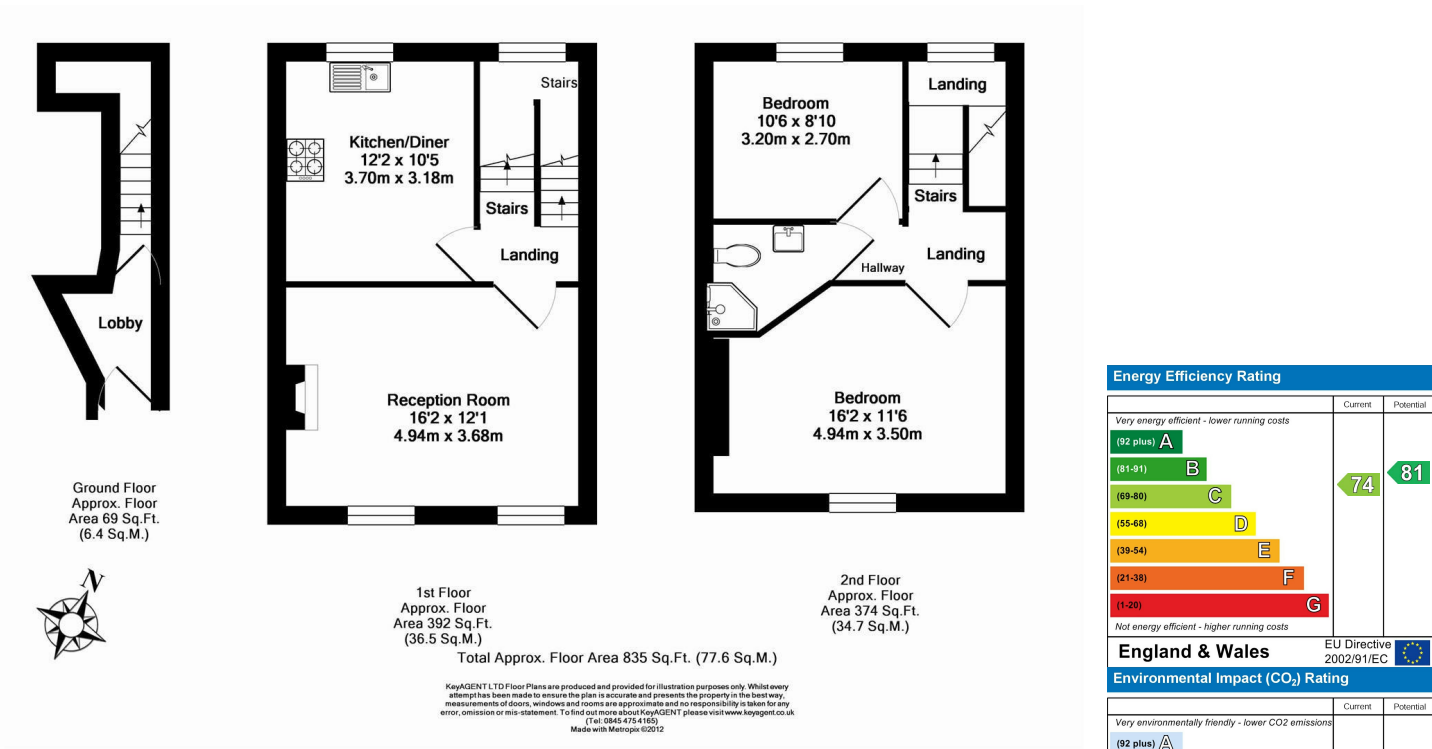

These particulars are designed to provide a guideline only and cannot be relied upon as a statement of fact. The description represents the opinion of the author and is not intended to provide false or misleading information. Any prospective purchaser should make further checks on its accuracy. All measurements are approximate and floorplans are for representation only.